

STATE WELL REPORT

Part 1

Driller's Log

Mississippi Department of Environmental Quality
Office of Land and Water Resources
P.O. Box 2309
Jackson, MS 39225-2309
(601)961-5210
(601)360-0535 (fax)

For Office Use Only:

Well #: M444
Aquifer: _____
E-Log #: _____

County: Desoto
Permit #: _____
Driller: James W. Major
Date drilling completed: 5-8-18

State Law requires that this report be prepared by the license holder responsible for the work and filed with the Department at the above address within 30 days of completion of drilling of the well or borehole.

Well Owner Information (Landowner if borehole is not for a water well)	Well or Borehole Location
Owner Name: <u>Mike Clark</u>	Latitude: <u>34°46'23.53"N</u> Longitude: <u>89°44'08.45"W</u>
Mailing Address: <u>5976 Myers rd.</u>	Method of Lat/Long (check one): Conventional Survey _____, USGS quad _____, Hand-held GPS <input checked="" type="checkbox"/> , Survey-grade GPS _____
<u>Byhalia</u> <u>MS</u> <u>38611</u>	<u>SE</u> <input checked="" type="checkbox"/> <u>SW</u> <input checked="" type="checkbox"/> <u>Sec 33</u> <input checked="" type="checkbox"/> <u>T 35</u> <input checked="" type="checkbox"/> <u>R 5</u> <input checked="" type="checkbox"/>
City State Zip Code	<u>3.5</u> Miles <u>SE</u> of <u>Ingram's Mill</u>
Telephone No. (<u>901</u>) <u>494-8160</u>	(Distance) (Direction) (Nearest Town)

Well / Borehole Data	
Date drilling started: <u>5-8-18</u> Date drilling completed: <u>5-8-18</u> Hole depth: <u>130'</u> Hole diameter: <u>7"</u>	
Location of the source of any surface water used for drilling: <u>N/A</u>	
Method of dosing and volume of Chlorine used in drilling and development: <u>50 ppm and greater</u>	
Logs run (circle all applicable): <input checked="" type="checkbox"/> No log run <input type="checkbox"/> Electric <input type="checkbox"/> Gamma Ray <input type="checkbox"/> Density <input type="checkbox"/> Sonic <input type="checkbox"/> Neutron <input type="checkbox"/> Other: _____	
Name of organization running log(s): <u>N/A</u>	
Purpose of borehole (circle one): <input checked="" type="radio"/> Water Well <input type="radio"/> Geotechnical/Geological Investigation <input type="radio"/> Ground Source Heat Pump <input type="radio"/> Seismic Survey <input type="radio"/> Other (describe) <u>N/A</u>	
<i>If drilling is not related to water well construction, skip the remainder of this block</i>	
Purpose of Well (circle all applicable): <input checked="" type="radio"/> Home <input type="radio"/> Industrial <input type="radio"/> Public Supply <input type="radio"/> Irrigation <input type="radio"/> Fish Culture	
Other (describe): <u>N/A</u>	
If a flowing well, method of flow regulation: Valve <u>N/A</u> Other (describe) _____	
Static Water Level: <u>40</u> feet [above or <input checked="" type="radio"/> below] land surface (circle one) Date measured: <u>5-8-18</u>	
Method of measurement (circle one): Steel tape <input type="radio"/> Electric tape <input type="radio"/> Air line <input type="radio"/> Other (describe): <u>String weight</u>	
Well depth: <u>130</u> Well grouted to a depth of: <u>50</u> feet Type of grout (circle one): Neat Cement <input type="radio"/> <input checked="" type="radio"/> Bentonite <input type="radio"/> Mix	
Casing length: <u>120</u> feet Casing diameter: <u>4</u> inches Type of casing: <u>PVC</u>	
Screen length: <u>10</u> feet Screen diameter: <u>4</u> inches Type of screen: <u>PVC</u>	
Screen slot size: <u>010</u> inches Setting depth: From <u>120</u> feet to <u>130</u> feet	
Type of completion (circle all applicable): <input checked="" type="radio"/> Gravel packed <input type="radio"/> Underreamed <input type="radio"/> Open hole <input type="radio"/> Natural Development	
Other (describe): <u>N/A</u>	
Top of lap pipe or reduction in casing: <u>N/A</u> feet	

If telescoped or more than one screen, describe on next page

RECEIVED
JUN 07 2018
BY OLWR

County: Desoto
 Permit #: _____

For Office Use Only:
 Well #: M444

The sketch below only required for water wells

If well telescopes, show depths on sketch.

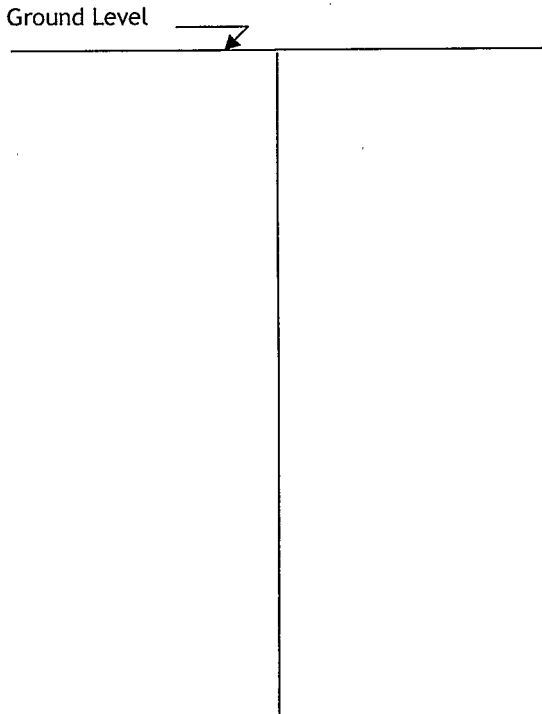

Description of formations encountered must be provided for all wells and boreholes, unless specifically exempted by regulations

Description of Formations Encountered	From (depth)	To (depth)
clay dirt	Ground level	15
white sand	15	40
white clay	40	60
white sand	60	130

If more than one screen, show location of each on sketch

Sketch the property layout and include the following:

- 1) the well location
- 2) any permanent structures on the property that may aid in locating the well
- 3) any roads, power lines, or other items that may aid in locating the property and the well
- 4) north arrow

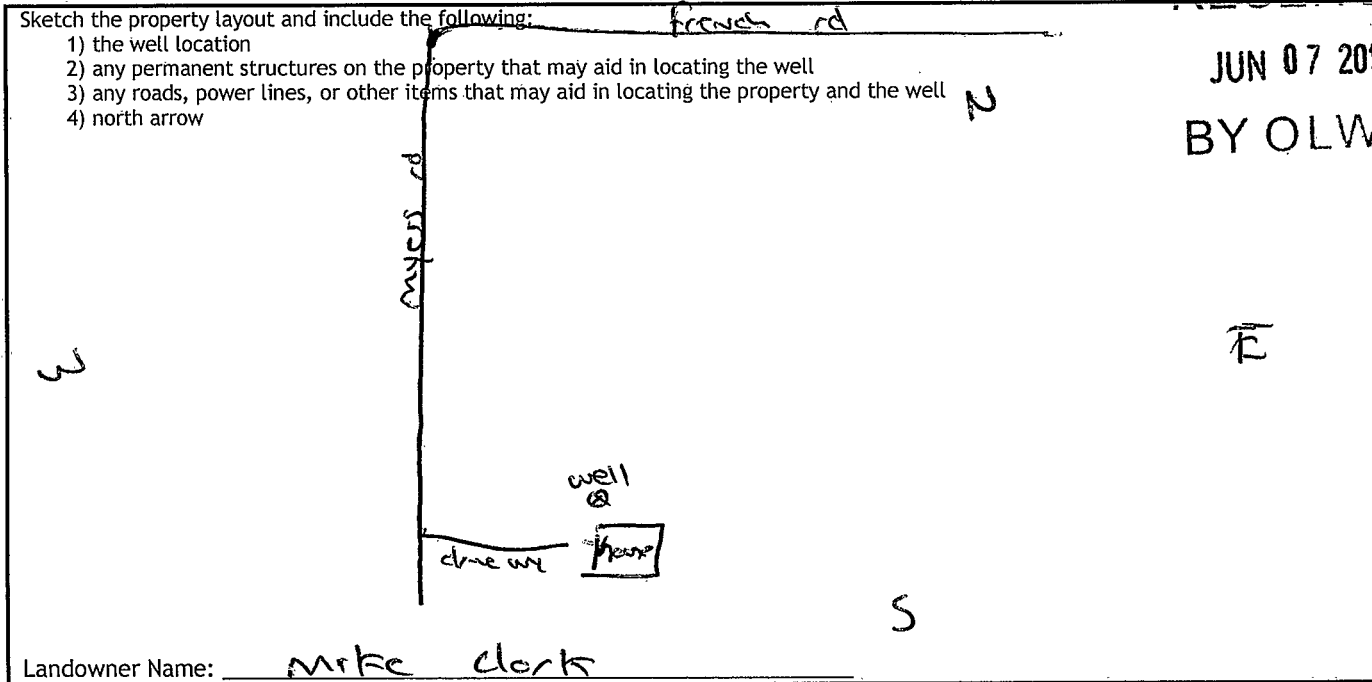

RECEIVED
 JUN 07 2018
 BY OLWR

Landowner Name: Mike Clark

I HEREBY CERTIFY that the well/borehole was drilled, constructed, and completed in accordance with all applicable requirements of the Mississippi Department of Environmental Quality and the Mississippi Department of Health regulations, if applicable, and state laws.

Jones W. Mason 0-620
 Print Name of Responsible Licensee and License No.

6-5-18
 Date

Jones W. Mason
 Signature of Licensee

STATE WELL REPORT

Part 2

Pump Installer's Completion Report

Mississippi Department of Environmental Quality
Office of Land and Water Resources
P.O. Box 2309
Jackson, MS 39225-2309
(601)961-5210
(601) 360-0535 (fax)

County: Desoto
Permit #: _____
Driller: Jones w-Mason
Date completed: 5-8-18
Copy information from block on Part 1

For Office Use Only:

Well #: MAAA
Aquifer: _____

This part of the report must be completed by a licensed water well contractor or a licensed pump installer. A copy of Part 1 of the report must be attached and both parts filed with the Department at the above address within 30 days of well completion.

Well Owner Information	Well Location
Owner Name: <u>Mike Clark</u>	Latitude: <u>34°46'23.53"N</u> Longitude: <u>89°44'08.45"W</u>
Mailing Address: <u>5976 Myers Rd</u>	Method of Lat/Long (check one): Conventional Survey _____, USGS quad _____, Hand-held GPS <input checked="" type="checkbox"/> , Survey-grade GPS _____
<u>Behalia</u> <u>MS</u> <u>38611</u>	<u>SE</u> ¼ <u>SW</u> ¼, Sec <u>33</u> T <u>3s</u> R <u>5w</u>
City State Zip Code	<u>3.5</u> Miles <u>SE</u> of <u>Mugraw Mill</u>
Telephone No. (<u>901</u>) <u>494-8160</u>	(Distance) (Direction) (Nearest Town)

Pump Type (circle one)

Submersible Turbine Air Lift Centrifugal Flowing Well Jet Piston Rotary Other (describe): _____

Date Pump Installed: 5-8-18 Rated Pump Capacity: 10 Gallons Per Minute

Is This Pump (circle one): New Repaired Replacement

Power Type (circle one)

Electric Diesel Gasoline Natural Gas Tractor PTO Windmill Other (describe): _____

Horse Power Rating of Motor: 3/4 Setting Depth: 80 feet Number of Stages: 8

Pump Test Data for Non Flowing Well

Date Well Tested: 5-8-18 Duration of Pump Test (minimum 4 hours): 24 hours

Static Water Level (A): 40 Feet Below Land Surface Pumping Water Level (B): N/A Feet Below Land Surface

Drawdown [(B) - (A)]: N/A Feet Below Land Surface Test Pumping Rate: 10 Gallons Per Minute

Method of measurement (circle one): Steel tape Electric tape Air line Other (describe): String / weight

Pump Test Data for Flowing Well

Measured shut in head: N/A feet.

Well yielded 10 GPM with a drawdown of N/A feet after 24 hours of pumping

Meter Installation

Meter Manufacturer: N/A Meter Serial Number: N/A

Meter Model Number/Name: N/A Type of Meter: N/A

Totalizer Register Unit and Multiplier Factor (AF x .001, gal x 1000, etc): N/A

Installation Date: N/A Meter installed by: N/A

Is This Meter (circle one): New Repaired Replacement

Important: By submitting the above information you are certifying that this meter was installed to manufacturer standards. For agricultural wells, a list of approved meters is on the MDEQ website.

I HEREBY CERTIFY that the above statements are true to the best of my knowledge.

Jones w-Mason 0-620 6-5-18 Jones w-Mason

Print Name of Pump Installer and License No. (if applicable) Date Signature of Pump Installer

RECEIVED
JUN 07 2018
BY OLWR